

**AKC Event # 2018716604**  
**FIELD TRIAL PREMIUM LIST**  
**North Dakota Pointing Dog Club**  
**Member of AFTCA**

**Rognlien Ranch, Towner, ND**  
**Friday September 14 - Monday September 17, 2018**

**LICENSED by the AMERICAN KENNEL CLUB (AKC)**

Entries are limited to the number of dogs that can be run during daylight hours.  
Entries will close when this limit is reached, if this occurs prior to the specified closing time.

This Field Trial will be held under the rules and procedures of the  
**AMERICAN KENNEL CLUB**

**OPEN TO ALL AKC REGISTERABLE POINTING BREEDS  
AND FDSB REGISTERED POINTING DOGS**

*Bitches in season may compete in ALL stakes.*

**ENTRIES WILL NOT BE DRAWN WITHOUT REGISTERING YOUR DOG AND PAYING  
VIA FIELD TRIAL CENTRAL'S WEBSITE**

Phone: (701)426 -0425 Email: [ndpdcentries@gmail.com](mailto:ndpdcentries@gmail.com)

Entries will close with the Field Trial Secretary at the same address on  
Tuesday, September 12, 2018 at 5:00 P.M. CDT

Drawing will take place at ,  
13835 34th ST NW, Bismarck, ND 58503 on Wednesday September 12, 2018 at 7:00 PM CDT  
Running Order will be posted at [www.ndpdc.org/](http://www.ndpdc.org/)

**Field Trial Marshals**  
Club Members

**JUDGES**

Ken Kuivenhoven—South Dakota  
Keith Hickam – South Dakota  
Lance Schulz—North Dakota  
Shane Anderson—North Dakota  
David Pomfret—Virginia  
Rob Pfennig—North Dakota

**SCRATCH POLICY AFTER CLOSING DATE**

Entries will be refunded in full only for dogs that have an injury or illness that prevents running in the registered stake or that are deceased prior to running in the registered stake. Club may require an appropriate veterinary certificate.

Marcie Schulz  
Field Trial Secretary  
13835 34TH ST NW  
Bismarck, ND 58503



**PURINA**  
**PRO PLAN**  
NUTRITION THAT PERFORMS®

## Stake, Schedule, Judges and Entry Fees

<u>Stake</u>	<u>Schedule</u>	<u>Judges</u>	<u>Entry Fee</u>
Open Derby	September 14, 2017 at 7:00 am	Lance Schulz Shane Anderson	\$55.00
Open Gun Dog	To follow Open Derby	Ken Kuivenhoven Rob Pfennig	\$55.00
Amateur Gun Dog	To follow Open Gun Dog	David Pomfret Keith Hickam	\$55.00

*Entry Fees Includes:*  
*\$3.50 AKC fee*  
*\$2.50 Field Trial Central fee*  
*\$1.00 Midwest Field Trial Association fee*

This trial is being run as a Flexible format trial and the club reserves the right to rearrange the running order of the stakes and add / rearrange judges if conditions warrant.

### COURSES AND BIRDS

All Stakes will be run on a single course, without a birdfield. Quail will be released in all stakes. Native game birds may be found and used on course in all stakes.

Horseback Handling will be permitted in all stakes .

Blank Ammo & Manufactured Barrel Guns Only!!!.

### PRIZES

Standard Rosettes to placed dogs in all stakes.  
In case of withheld placements, money stays with club

### CLUB OFFICERS

President: Lance Schulz, 13835 34th St NW, Bismarck, ND 58506  
Vice President: Shane Anderson, 13251B Highway 1804, Williston, ND 58801  
Secretary: Kelly Jarmuzek, 2594 Charlotte Dr N., Mandan, ND 58554  
Treasurer: Janet Kuivenhoven, 13638 SD HIGHWAY 20, FIRESTEEL, SD 57633

### FIELD TRIAL COMMITTEE

Chair: Kelly Jarmuzek  
Bill Holtan, Dave Pomfret, Rob Pfennig

## Entries open 8/15/2018

[www.fieldtrialcentral.org](http://www.fieldtrialcentral.org)

- 1) Create an Owner/Handler account
- 2) Add Dogs (to save dogs profile, click on publish in the upper right corner of the page)
- 3) Find event (North Dakota)
- 4) Add qty of dogs in each stake
- 5) Enter dogs name in search bar to find dogs profile.
- 6) Verify dogs information is correct
- 7) Checkout process will take you to a PayPal checkout process, you DO NOT need a PayPal account. Choose the “pay with debit or credit card” option under the PayPal login

If you have any questions, call Lance at 701.426.0425

We appreciate your support of using FieldTrialCentral.org as they are working to reduce club tasks and focus on getting dogs to the line and handing our awards!



## Welcome to our 2018 Fall Field Trial

No arrivals before 12:00 PM on Thursday, September 7th

No training before or after trial

Course ride late Friday afternoon.

Potable water available.

Must be off grounds by 10:00 AM on Monday, Wednesday September 13th

### AREA LODGING

Cobblestone Inn & Suites  
402 US-2, Rugby, ND 58368  
(701) 881-3000

### FOOD & BEVERAGE

Breakfast of Coffee, Juice, and rolls will be provided complimentary each morning. Lunches will be served on the grounds daily for a nominal fee. Sodas and water will be available throughout the days. Saturday evening we will cook dinner on the grounds.

### EMERGENCY NUMBERS

**Police:** McHenry County Sheriff  
407 Main St South, Room 303  
Towner, ND 58788  
Emergency - 911  
Office - (701)537-5633  
Non-Emergency Dispatch - (701)328-9921

**Fire:** Towner Fire Department - 911

**Hospital:** Heart of America Medical Center  
800 South Main Ave  
Rugby, ND 58368  
(701)776-5261

**Ambulance::** Towner Fire Department - 911

**Veterinary (Dogs and Horses):** Towner Vet Clinic  
304 6th Ave NW,  
Towner, ND 58788  
(701) 537-2030

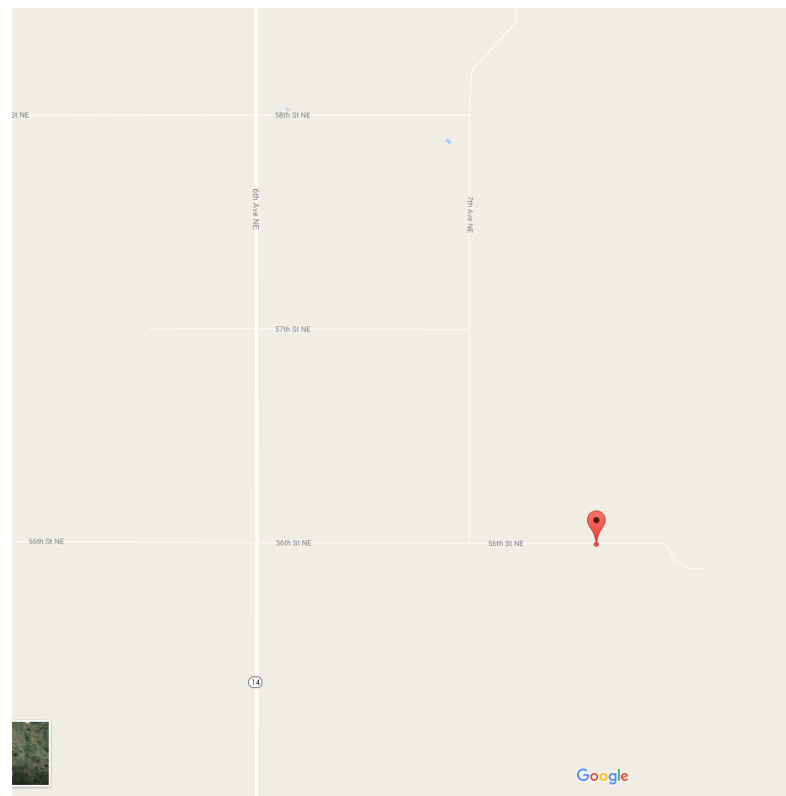

### DIRECTIONS

**From I-94,** take the Hwy 281 North Truck route that is west of Jamestown, ND.. This will allow you to avoid the city traffic. Following Truck 281/281, go north 3.5 miles and take left on Hwy 52, follow Hwy 52 for 121 miles and take a right on Highway 14. Go north on Highway 14 for 21 miles, turn right onto 56th St and go 1.5 miles to drive on left.

**From Highway 2,** go south on Highway 14 for 6 miles, turn left onto 56th St and go 1.5 miles to drive on left.

If you are lost or need other local information you can call Dave at 540-229-8045

48°13'29.3"N 100°25'06.9"W  
48.224817, -100.418576